



UNITECH

Isam Kabbani Group of Companies
www.unitech-ikk.com | www.unipro-ikk.com

INSULATION AND PROTECTION SOLUTIONS

FLAT ROOF WATERPROOFING ROOFTOP

INTRODUCTION

The Effisus Rooftop system not only transforms your roof into a garden but is also a complete, efficient, and sustainable system for living roofs. Merge your building with nature and make your urban environment a more welcoming space! Effisus Rooftop guarantees a roof's waterproofing and maximises the roof's (and the building's) energy efficiency by protecting a building at its most vulnerable points, given their exposure to atmospheric conditions, increasing its "robustness" Effisus Rooftop guarantees you that you'll be applying a complete and integrated system that really is sustainable, from its carefully-selected components, to the value-adding features of a gardened roof:

- . Ability to slowly dissipate energy during winter while increasing thermal protection during summer;
- . Partial retention of rainwater, purifying it into the subsoil and reducing flood hazard;
- . Good acoustic insulation;
- . Absorption of CO2 and of a portion of other pollutant gases, among other advantages.

THE EFFISUS ROOFTOP SYSTEM COMPRISES SEVERAL ELEMENTS, NAMELY THE FOLLOWING:

- **Plant cover and specific soil substrate;**
- **Effisus Roofdrain Geocomposite;**
- **Effisus Roofleece Geocomposite;**
- **Effisus Ecoroof Membrane;**
- **Effisus-Approved Thermal Insulation;**
- **Effisus Vap Membrane.**

WHY SHOULD YOU CHOOSE EFFISUS ECOROOF SYSTEM?

EFFICIENCY

- Complete, integrated system
- Low maintenance requirements
- Non-intrusive systems
- Natural protection of the sealing system
- Possibility of achieving an immediate living roof
- Versatility - can be applied to flat, curved, or slanted roofs
- Increases a building's energy efficiency

SUSTAINABILITY

- Safe components for a building's occupants
- System and building longevity
- Low energy consumption during manufacturing, installation, and execution
- Recyclable or re-usable
- Contributes towards the sustainability of urban environments
- Reduced greenhouse gas emissions
- Reduced flood hazard
- Absorption of pollutant gases
- Adds value to a building

UP-WAY SYSTEMS

INNOVATION, QUALITY, AND TECHNICAL EXPERTISE

Effisus Rooftop is an integrated system of superior quality the components of which were carefully selected based on the premise of sustainability while guaranteeing full waterproofing of a building's roof. These characteristics make Effisus Rooftop an innovative, differentiated system that lets you safely elect a living roof for your building assisted by Up-Way Systems' specialised technical expertise!



EFFISUS ROOFYARD SYSTEM COMPONENTS

Plant cover and Specific soil substrate

Seeding and plant cover.

Specific soil substrate recommended as a function of project specifications.

Effisus Roofdrain Geocomposite

Drainage system, guaranteeing adequate water retention for plant growth.

Supplied including filter to ensure water retention bladders are not silted with solid particles.

Prevents clogging due to substrate accumulation.

Effisus Roofleece Geocomposite

High-density geotextile fabric to protect the sealing membrane.

Effisus Ecoroof Membrane

Sealing membrane applied by heat-welding.

Effisus-Approved Thermal Insulation

Thermal insulation of excellence offering good resistance to compression:

- Effisus Ecork Insulation, expanded insulation corkboard (recyclable natural product that can be re-used, offering good thermal, acoustic, and vibration insulation).
- Effisus PIR Insulation, polyisocyanurate panel approved for application with Effisus Roof yard (high thermal efficiency even when applied in limited thickness). Effisus Yap Membrane Water vapour barrier to increase insulation efficiency.



EFFISUS ROOFYARD ACCESSORIES

Effisus Ecoroof Coated Sheet

Metal plate lined with Effisus Ecoroof Membrane.

Effisus Bonding SB Adhesive

Adhesive to bond the Effisus Ecoroof Membrane to metal or concrete surfaces.

Effisus Setup PR Cleaner

Membrane cleaner for application prior to heat-welding.

Effisus Block JP Sealant

Sealant to guarantee effective bonding between system components.

Effisus Adjoin GS Tape

Adhesive tape to seal overlapping joints of EffisusVap Membrane water barrier.

Effisus 2Bond GO Tape

Sealing tape to guarantee waterproofing between the membrane and the water vapor barrier.



1 - PLANT COVER AND SPECIFIC SOIL SUBSTRATE

Seeding in compliance with plant cover specifications or with plants, enable you to immediately achieve a living roof. A specific soil substrate is selected as a function of the desired type of garden roof, the selected plant cover, or the location of the building in question.

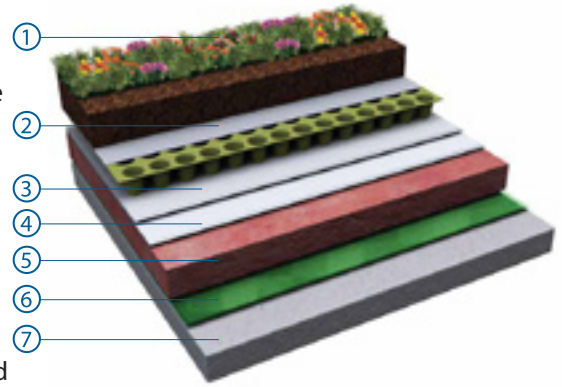

2 - EFFISUS ROOFDRAIN GEOCOMPOSITE

Effisus Roofdrain Geocomposite is a drainage system that retains only the necessary amount of water to maintain the Effisus Roofyard system and drains excess water. It includes a filter for purposes of filtering water and preventing clogging of the drainage system's water retention bladders with substrate particles. The systems are specifically tailored to the type of plant cover desired and designed as a function of the amount of water they require, adapted to the building's specifications.

3 - EFFISUS ROOFLEECE GEOCOMPOSITE

Effisus Roofleece Geocomposite is a high-density geotextile fabric used to protect the sealing membrane.

4 - EFFISUS ECOROOF MEMBRANE

The Effisus Ecoroof sealing membrane has been approved and employed in a range of leading projects, both domestically and abroad. It does not contain plasticisers, is chlorine- and halogen-free, does not contain other chemicals harmful to the environment, and is 100% recyclable and re-usable.

Membranes are joined by heat-welding, a clean and effective method. Maintenance requirements are minimal and the material can be repaired over the entire course of its useful life. The Effisus Ecoroof Membrane offers excellent resistance to exposure to solar radiation and wide temperature change.

5 - EFFISUS-APPROVED THERMAL INSULATION

The Effisus Roofyard system offers a range of thermal insulation options. Unlike some conventional solutions, those options ally technical efficiency to sustainability. Those options are - Effisus Ecork Insulation, expanded insulation corkboard, a natural product resistant to compression offering good water vapour permeability and excellent thermal insulation; and Effisus PIR panel approved for application with Effisus Roofyard, polyisocyanurate panel of high resistance to compression guaranteeing high thermal efficiency even when applied in limited thickness.

6 - EFFISUS VAP MEMBRANE

The Effisus Vap Membranewatter vapour barrier, together with the Effisus Ecoroof sealing elements, ensures effective humidity management and prevents any condensation potentially causing degradation to the thermal insulation and producing mold or fungus ... This element guarantees greater longevity and efficiency for the thermal insulation.

7 - CONCRETE SLAB



EFFISUS ROOFYARD LATEST-GENERATION LIVING ROOFS

By electing to build an Effisus Roofyard living roof you'll be protecting the sealing system from exposure to UV radiation, increasing its longevity. Effisus Roofyard guarantees your roof's full sealing by using efficient and sustainable membranes and waterproofing accessories, in combination with the extra benefits of the Effisus Roofdrain Geocomposite drainage system. The efficient and sustainable solutions provided by this system, consisting of several, carefully selected component!,, are complete (containing all necessary elements for proper execution) and tailored to each project's specific requirements.



EFFISUS ECORK LIVING ROOFS WITH CORK

Up-Way Systems and Amorim Isolamentos S.A. have joined forces to promote cork, a superior quality efficient and sustainable Portuguese material. The Effisus Ecork option for living roofs is an efficient and sustainable integrated system. This system allies waterproofing effectiveness to the excellence of Effisus Ecork expanded insulation corkboard features, namely its excellent dimensional stability, unlimited durability, good compression-resistance, and good thermal, acoustic, and vibration insulation characteristics.



EFFISUS ECOROOF LATEST-GENERATION ROOFING

Effisus Ecoroof is a complete, efficient, and sustainable integrated system that guarantees a roof's waterproofing while maximising its energy efficiency. It is far more durable and robust than traditional systems. Effisus Ecoroof provides a range of mechanical protection options for flat roofs and its full adherence option is suitable for application to steeply slanted and curved roofing.

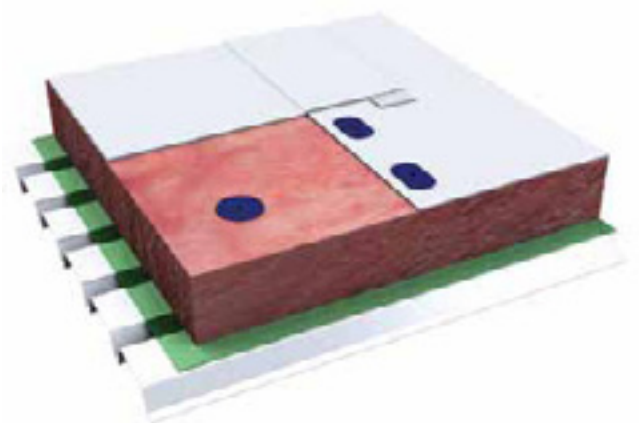

LOCATIONS

KIGDOM OF SAUDI ARABIA

unitech.ksa@ikkgroup.com

Jeddah

Tel : +966 12 627 8222
Fax: +966 12 627 8722

Jeddah - Ghurab Showroom

Tel : +966 12 667 2000
Fax: +966 12 661 4306

Mak kah/Taif

Tel : +966 12 541 1206
Fax: +966 12 532 1675

Mad inah

Tel : +966 14 842 1095
Fax: +966 14 842 1090

Yanbu

Tel : +966 14 390 1499
Fax: +966 14 322 7101

Khamis Mushayt

Tel : +966 17 237 5929
Fax: +966 17 237 8783

Najran

Tel : +966 17 546 3873
Fax : +966 17 546 3873

Al Baha

Tel : +966 17 237 5929
Fax: +966 17 237 8783

Sharorah

Tel : +966 17 532 8153
Fax: +966 17 532 8153

Gizan

Tel : +966 17 321 6660
Fax: +966 17 321 0665

Riyadh North

Tel : +966 11 415 5465
Fax: +966 11 456 6627

Riyadh South

Tel : +966 11 448 0112
Fax: +966 11 447 7421

Riyadh West

Tel : +966 11 431 6271
Fax: +966 11 431 7642

Riyadh East

Tel : +966 11 448 0112
Fax: +966 11 447 7421

Qassim / Buraidah

Tel : +966 16 382 3946
Fax: +966 16 385 2186

Hail

Tel : +966 16 543 3931
Fax: +966 16 543 3935

Skakah / Qurayyat

Tel : +966 14 626 3904
Fax: +966 14 626 3905

Tabuk

Tel : +966 14 423 5203
Fax: +966 14 423 5203

Hafr el Batin

Tel : +966 13 729 3644
Fax: +966 13 729 3644

Dammam

Tel : +966 13 859 0097
Fax: +966 13 857 8177

Jubail

Tel : +966 13 361 4390
Fax: +966 13 362 4499

Hofuf

Tel : +966 13 530 1474
Fax: +966 13 530 7144

FACTORIES

SFSP - KSA

sfsp.jeddah@ikkgroup.com

Specialized Factory for Steel Products

3rd Industrial City / Jeddah

Tel: +966 12 637 4482
Fax: +966 12 636 1963

SFSP / UAE

sfsp.uae@ikkgroup.com

SIGMA Factory for Steel Products

DIC (Dubai Industrial City)

Tel : +971 4 818 1919

SFSP / Egypt

sfsp.cairo@ikkgroup.com

Specialized Factory for Steel Products

6th of October City Giza

Tel : +20 2 3820 6477
Fax: +20 2 3820 6036

SFSP / Lebanon

sfsp.lebanon@ikkgroup.com

Specialized Factory for Steel Products

Tanayel, Bekaa

Tel: +961 8 514 290
Fax: +961 8 514 291

BAHRAIN

unitech.bahrain@ikkgroup.com

Manama

Tel : +973 17 874 897
Fax: +973 17 789 470

KUWAIT

unitech.kuwait@ikkgroup.com

Kuwait City

Tel : +965 2 4924 937
Fax: +965 2 4924 938

UNITED ARAB EMIRATES

unitech.uae@ikkgroup.com

Dubai - Al Rashidiyah

Tel : +971 4 2591 773
Fax : +971 4 2591 774

Abu Dhabi - Musaffah

Tel: +971 2 552 3393
Fax: +971 2 552 5499

OMAN

unitech.oman@ikkgroup.com

Muscat

Tel : +968 24 591 006
Fax : +968 24 597 006

JORDAN

unitech.jordan@ikkgroup.com

Amman

Tel : +962 6 556 3030
Fax: +962 6 554 7911

Aqaba

Tel : +962 6 556 3030
Fax: +962 6 554 7911

PAKISTAN

unitech.pakistan@ikkgroup.com

Karachi - Clifton

Tel-Fax : +92 21 35826120

EGYPT

unitech.egypt@ikkgroup.com

Cairo 6th of October City

Tel : +20 2 3820 6477
Fax: +20 2 3820 6036

LEBANON

unitech.lebanon@ikkgroup.com

Beirut

Tel : +961 1 858 277
Fax: +961 1 858 276

ENGINEERING, DESIGN, MARKETING & MULTIMEDIA

Unitech Deutschland GmbH

Germany

unitech.germany@ikkgroup.com

Stuttgart

Tel : +49 711 6868 7222
Fax: +49 711 6868 7223

Multi-D s.a.r.l

Lebanon

multi-d@ikkgroup.com

Multi-d Beirut

Tel : +961 1 841 155
Fax: +961 1 841 156

R&D DEPARTMENT

Saih Suhaib-3, Opp DEWA Substation, Dubai Industrial City, Dubai, UAE

Tel : +971 4 818 1944 - Mob: +971 55 517 0841

Email: unitech.uae@ikkgroup.com - abed.demachkieh@ikkgroup.com